

## REMOVAL

1. REMOVE ROOF HEADLINING  
(See page [BO-111](#))
2. REMOVE NO.1 COOLER AIR DUCT

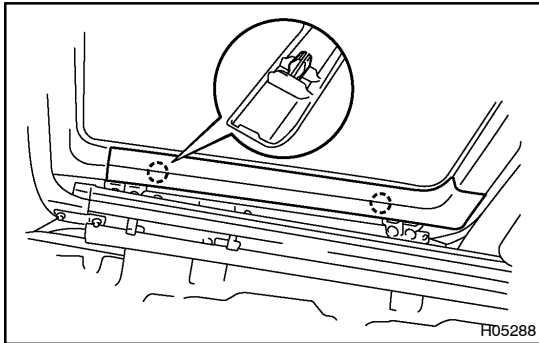

### 3. REMOVE GARNISH

Using a screwdriver, remove the garnishes.

HINT:

Tape the screwdriver tip before use.

### 4. REMOVE SLIDING ROOF GLASS

- (a) Remove the 4 nuts.
- (b) Pull the glass upward to remove it.

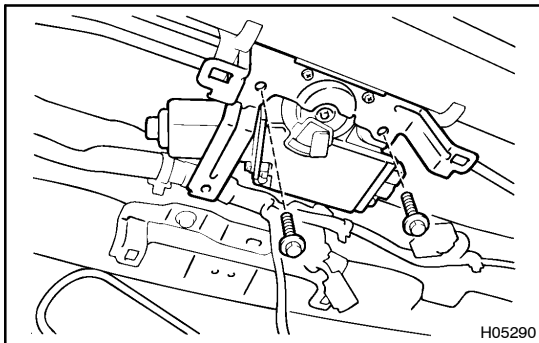

### 5. REMOVE DRIVE GEAR

**NOTICE:**

**Remove the drive gear with the sliding roof fully closed.**

- (a) Disconnect the connector.
- (b) Remove the 2 bolts and drive gear.

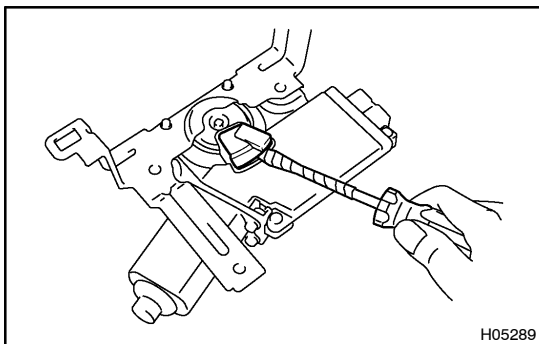

- (c) Using a screwdriver, remove the cam plate cover.

HINT:

Tape the screwdriver tip before use.

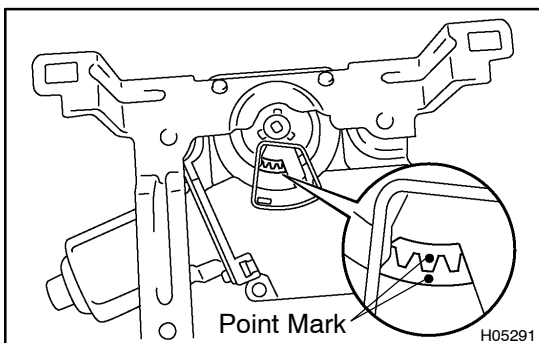

- (d) Turn the drive gear to align the point marks as shown in the illustration.

- (e) Install the cam plate cover.

**NOTICE:**

**At the time of installation, please refer to the following item.**

**If the sliding roof position and drive gear fully closed position are not matched, the sliding roof does not operate normally.**

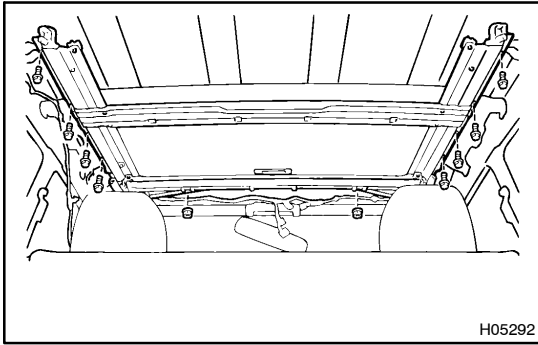
**6. REMOVE SLIDING ROOF HOUSING**

- (a) Remove the 4 drain hoses from the housing.
- (b) Remove the room light wire harness.
- (c) Remove the 8 bolts, 2 nuts and sliding roof housing.